

0 1 2 4 8
Scale 1: 100
Status
MS3

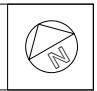
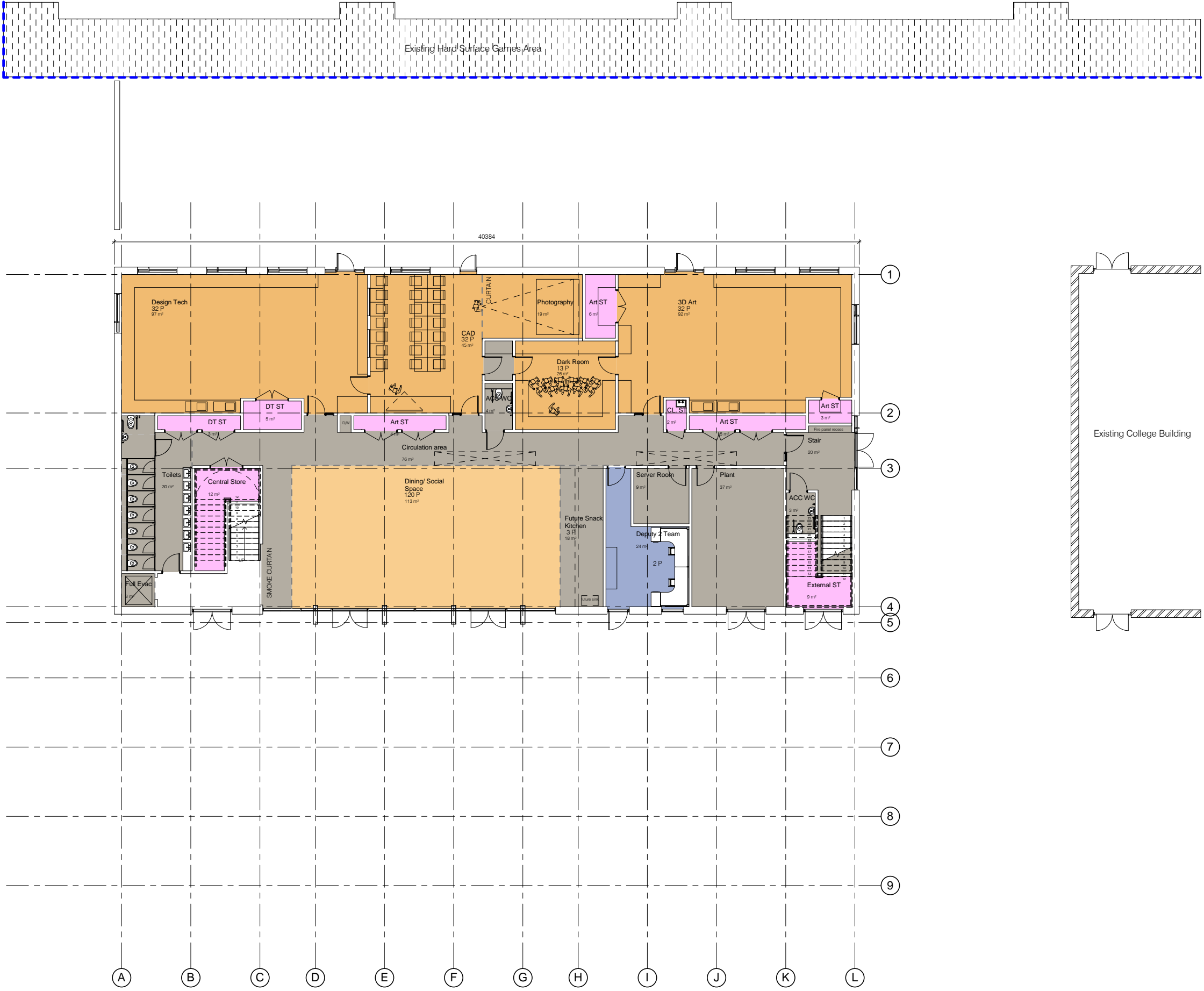

6	Plans revised	10.9.18	CB
5	Plans Updated	05.09.18	
4	Fire Revisions	30.08.18	NP
3	MS3 Initial Preview	23.08.18	NP
2	CAD Module Altered	3.8.18	NP
1	Pre-App	17.07.18	NP
No.	Revision	Date	Init.

Job:
Cambourne Village College PH 3A
Drawing:
PHASE 3A - GA PLANS - GROUND
Client:
Kier

**FRANK
SHAW
ASSOCIATES
LIMITED
ARCHITECTS**

Jubilee House Mill Lane Sawston Cambridge CB22 3HZ
Tel 01223 838100 Fax 01223 838123 www.frankshawassociates.co.uk

Scale	Date	Drawn/Checked
1 : 100@A1	05/30/18	NP
Job Number	Dwg No	Rev
18010 18010-PA-1000	PA-1000	6

1 Ground Floor Plan
1 : 100